

I Motorised Pop-up Socket with Built-in Qi Wireless Charger and Bluetooth Speak

Product Dimensions

Installation Guide

①

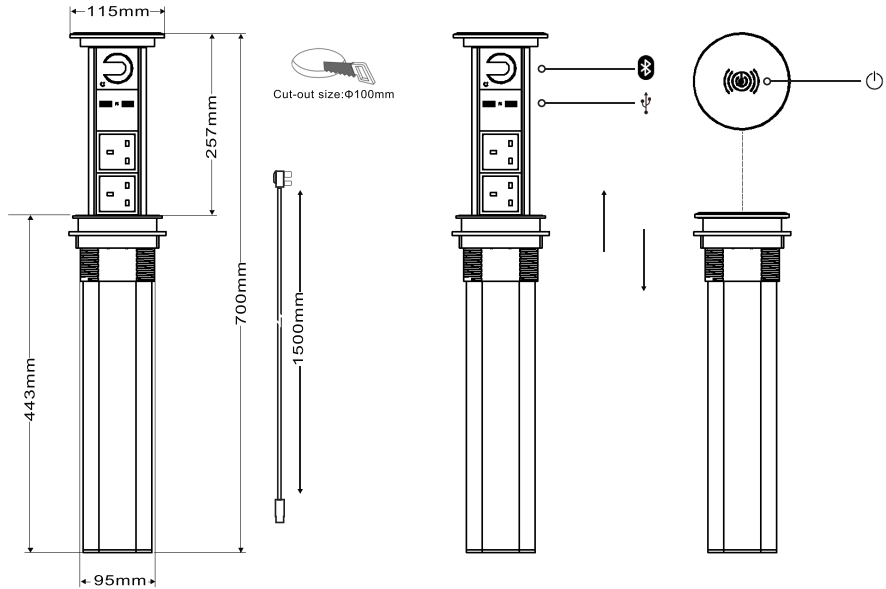
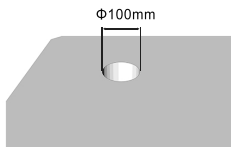

Install this product with care.
To make a 100mm hole in the
worktop.

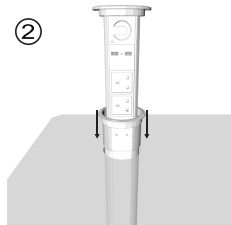
②



Insert the product body into the
hole.

③

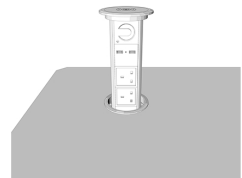

Ensure the product is evenly
installed without gap to the surface.

④

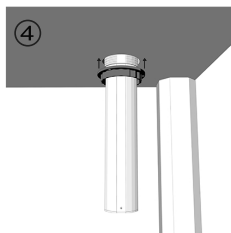

Tighten the washer from the
underneath of worktop.

⑤

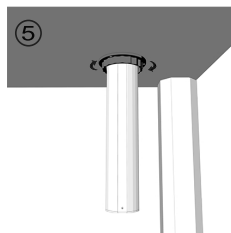

Ensure the product body is securely
fixed on workshop.

⑥

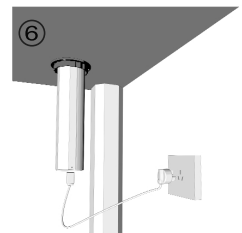

Connect the supplied power lead
to the connector on the base
of the product body.

Technical Parameters:

Rated voltage range: AC100-264V

Rated Frequency: 50/60Hz

Rated Current: 13A

External Dimensions: 443x115mm

Hole Cut-out size: 100mm

USB Power: 5V 2A in total.

Wireless Charger Power: 9V 1.2A

Applications:
Kitchen Worktops
Office Desks
Reception Desks
Caravans
Dressing Tables

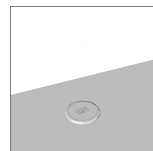
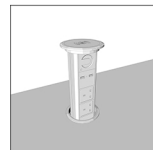

How to use the product:

1.To start / Close the motorised pop-up socket:

Press the button on the top of the unit for 3 seconds to power up the product, then touch the button to raise or lower the socket. The delay function is designed to prevent accidental operation triggered by children and animals.

2.Anti-collision function:

If the product encounters an obstruction during a raising operation, the anti-collision function will be activated and the unit will pause. To return the normal raising operation, please press the button on the top of the product once again.

3.Anti-pinch function:

If the unit is obstructed during a closing operation, the anti-pinch function will be activated and the unit will reverse the closing direction and pause further movement. To return the normal closing operation, please press the button on the top of the product once again.

4.USB charger:

The product is equipped with 2 x USB charge sockets. The peak charging power is 5V 2A for the USB charging unit. The actual charging power is determined by the equipment connected to the USB sockets.

5.Wireless Charger:

The product is equipped with a built-in wireless charger. The peak charging power is 9V 1.2A. Simply place your wireless charging enable device on the lid of the product. The charge will automatically start when the induction is paired.

6.Bluetooth Speaker:

You may connect to the built-in Bluetooth speaker in the product by applying standard Bluetooth Pairing Practice.

* The name of the speaker is: Motorised Socket.

Please note that, the speaker unit can only pair to one device at any time. If you want to pair to another unit, please press the reset key at left bottom corner of the speaker unit.

CAUTION

This motorised pop-up socket must be securely installed on a solid horizontal surface for safe operation.

CHL, GORSE MILL, OL9 9RJ

EU Authorised Representative: Authorised Rep Compliance,
Ground Floor, 71 Lower Baggot Street, Dublin, Ireland,
D02P593.



Waste electrical products should not be disposed of with household waste. Please recycle where facilities exist. Check with your Local Authority or local store for recycling advice.